

CHORUS AUDIO RACK





CHORUS AUDIO RACK

The modular audio rack is built with 30 mm solid hardwood and stainless steel spikes. This unique and functional model gives you the ultimate listening experience. Each of the four tiers is separated with stainless steel spikes to ensure that there is no transmission of vibrations and frequencies across tiers - giving superior clarity and stability to the music. Its integrated wire management and open design ensure adequate airflow to keep your equipment cool. Being modular, this rack opens up exciting opportunities to adapt easily to your future needs







TECHNICAL SPECIFICATIONS

Hardware :

Stainless Steel 304 grade spikes and bush

Shelves :

modula, 30mm solid wood

Sustainability :

each shelf can bear the load of 50kgs

Outer Dimension :

615 x 460 x 860 (mm)

Inner Dimension :

527 x 372 x 860 (mm)

Design :

Open design for integrated wire management



AUDIO RACK 2

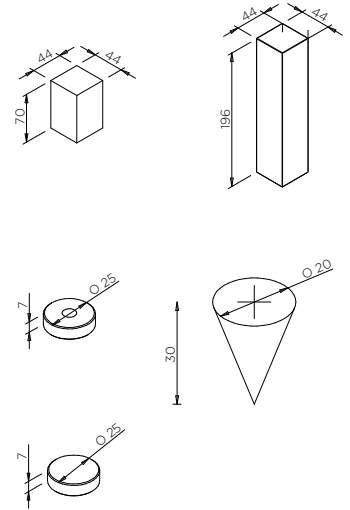
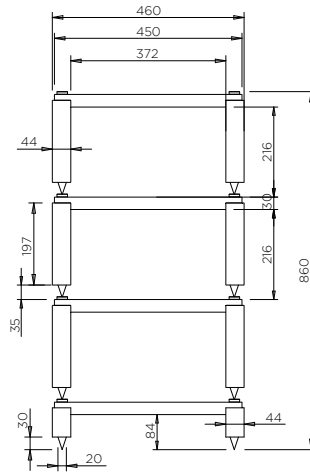
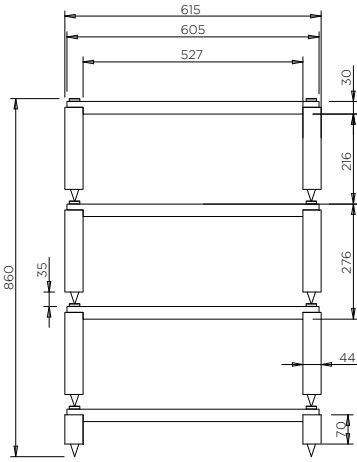
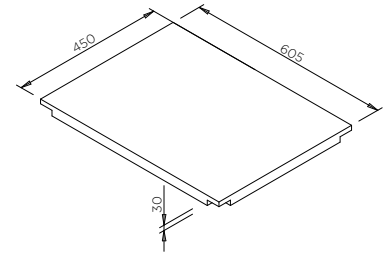
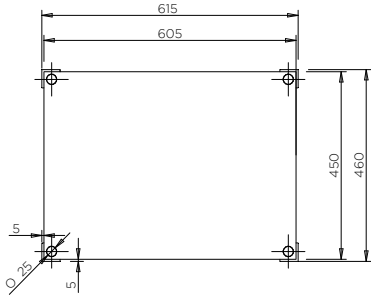

ALL DIMENSION ARE IN MM



